

PERFORMANCE

Sub P 25

10" (25cm) subwoofer



- Polypropylene cone
- For vented box

SPECIFICATIONS

Nominal power	200W	
Maximum power	400W	
Sensitivity (2,83V/1m)	90dB	
Cone	Polypropylène	
Surround	Butyl	
Nom. impedance	4 Ohms	
DC resistance	3.6 Ohms	
VC diameter	50mm	1"
VC height	18.5mm	0 ⁵ / ₁₆ "
Former	Kapton	
Layers	4	
Wire	Copper	
Inductance		
Xmax	5.25mm	0 ¹ / ₁₆ "
Magnet d x h	145mm x 75mm x 20mm	-
Magnet weight	1000gr	-
Flux density		
Gap height	8mm	0 ¹ / ₈ "
Net weight	3850g	0.50 lb

PARAMETERS

Fs	48Hz
Vas	16.02 l
Qts	0.621
Qes	0.71
Qms	4.93
Re	3.6 Ohms
Sd	346.36cm ²
Cas	1.14 E-07m ⁵ /N
Mas	95.59kg/m ⁴
Ras	5871.82 Ohms.ac
Cms	951µm/N
Mms	114.67g
Rms	7.077kg/s
Ces	651.22mF
Les	16.74mH
Res	25 Ohms
BI	13.27N/A
SPL	85.87 dB/W/m

FREQUENCY RESPONSE/IMPEDANCE

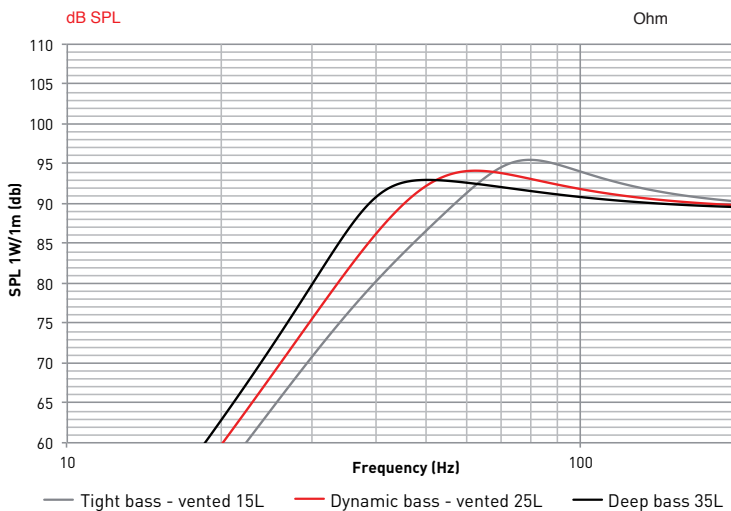

MECHANICAL DRAWING

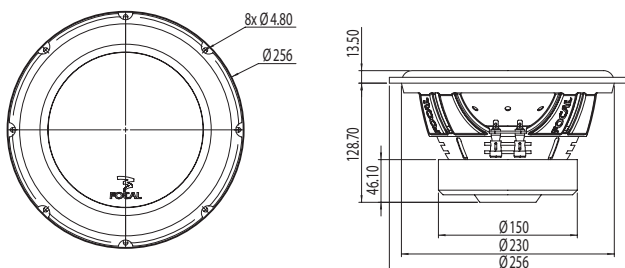

SUGGESTED APPLICATION

Load	Volume	Port diameter	Port length	Freq. F-3 (Hz)	
Vented	15l	8cm (3 ³ / ₅₂ "	35cm (13 ²⁵ / ₃₂ "	45Hz	tight
Vented	25l	8cm (3 ³ / ₅₂ "	30cm (11 ¹³ / ₁₆ "	37Hz	dynamic
Vented	35l	8cm (3 ³ / ₅₂ "	26cm (10 ¹⁵ / ₆₄ "	31Hz	deep