

100 OD8-T

Product Data Sheet

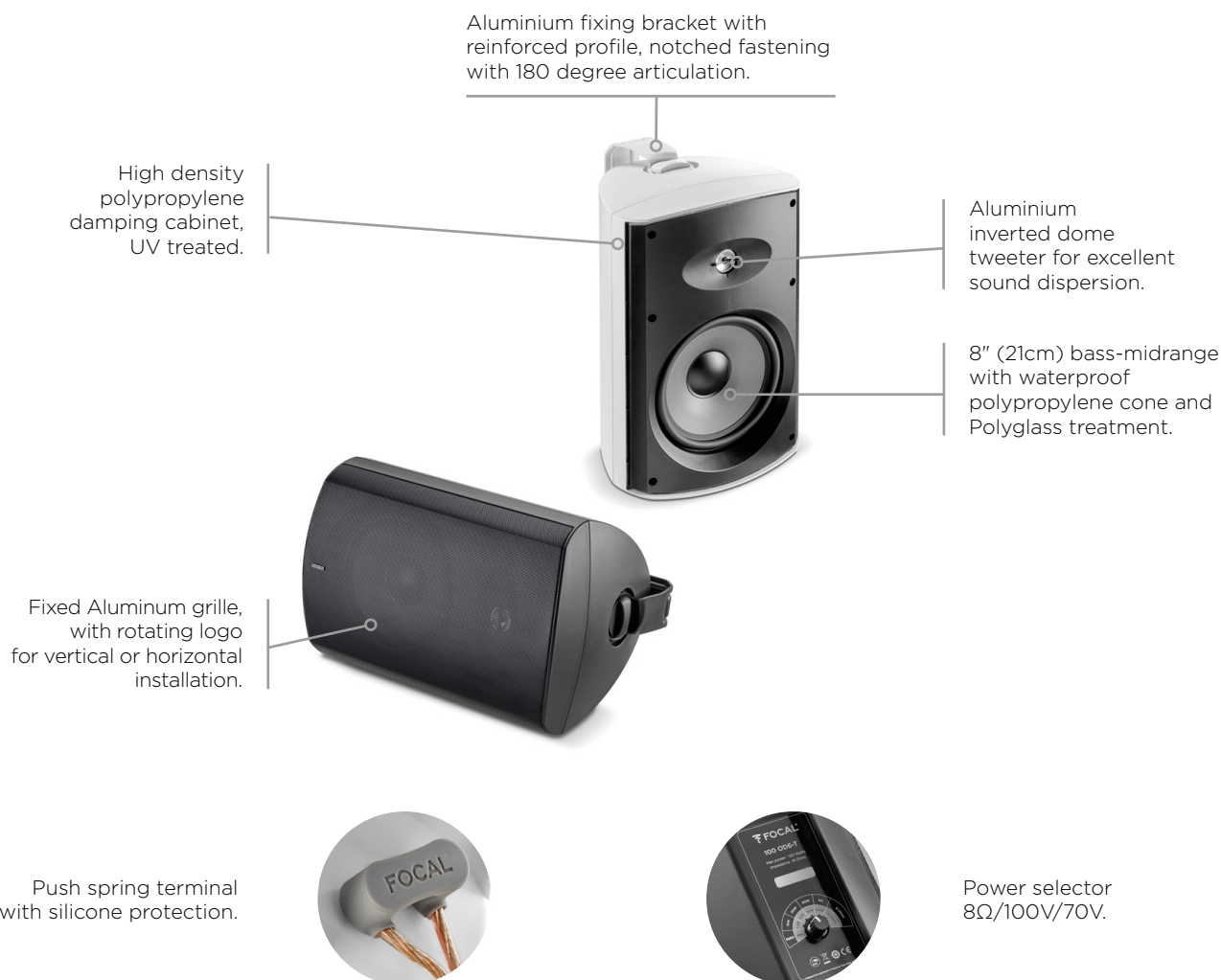

Key points

- Technical design, IP66 certified (water and dust)
- Ready-to-paint grille and cabinet
- 8 ohm/70V/100V mode by switch

Finishes



Type	Outdoor loudspeaker
Speakers	Aluminium inverted dome tweeter 8" (21cm) waterproof woofer with Polyglass treatment
Sensitivity (2.83V/1m)	88dB
Frequency response (+/-3dB)	60Hz-23kHz
Low frequency point (-6dB)	45Hz
Power in 8 Ω	120W
Power in 70 V	15/30/60W
Power in 100 V	30/60/120W
Recommended amp power	20-150W
Filtering frequencies	2,800Hz
Dimensions (LxPxH) with brackets	10.2x11x15.4" (258x280x390mm)
Net weight with brackets	12.6lbs (5.8kg)

8Ω			
70V	15W	30W	60W
100V	30W	60W	120W

Measurements Directivity

Horizontal

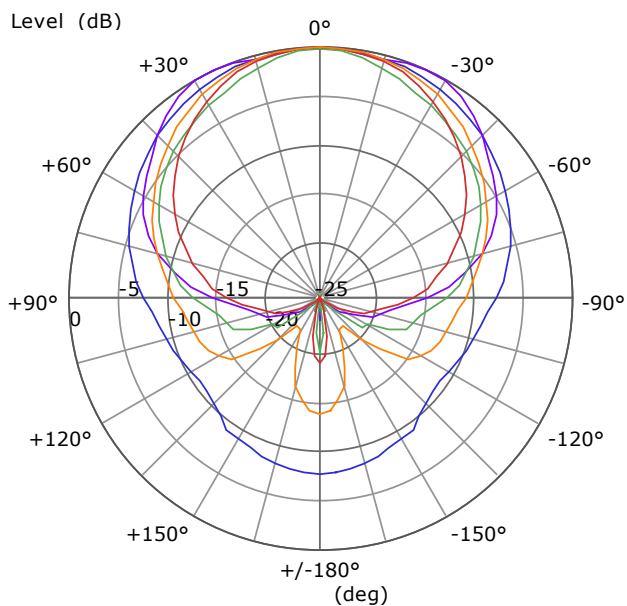

- Curve at: 500 Hz
- Curve at: 1 kHz
- Curve at: 2 kHz
- Curve at: 4 kHz
- Curve at: 8 kHz

Vertical

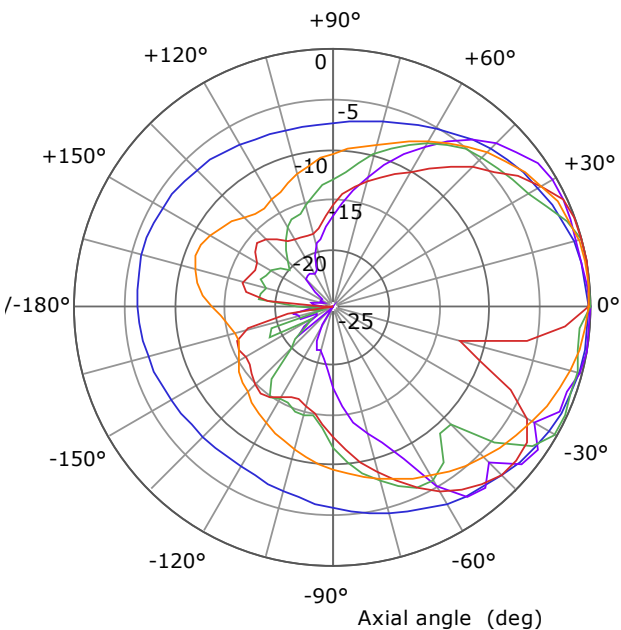

- Curve at: 493.5 Hz
- Curve at: 1 kHz
- Curve at: 2 kHz
- Curve at: 4 kHz
- Curve at: 8 kHz

Frequency Response

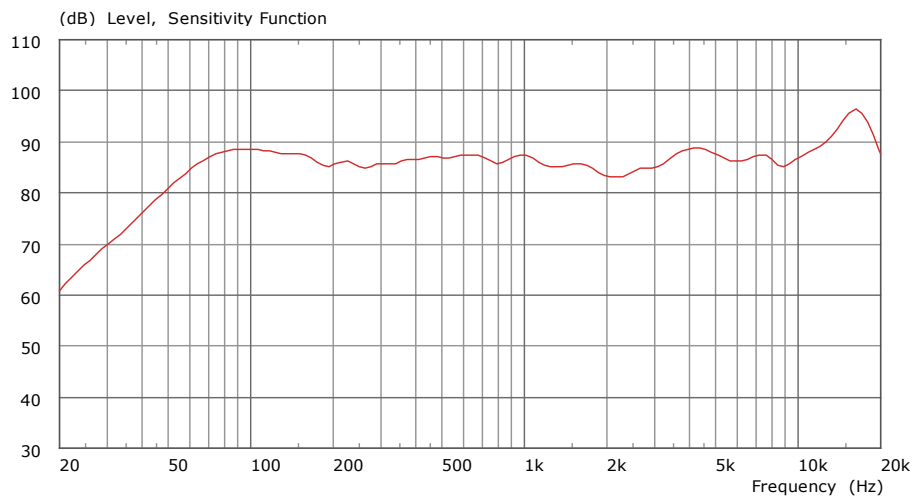

100 OD8-T Speaker level Calculation Table

Nominal sensitivity	87dB						
Power/Distance	1m	2m	5m				
1W (2.83V)	88dB	82dB	74dB				
10W (8.94V)	98dB	92dB	84dB				
20W (12.6V)	101dB	95dB	87dB				
30W (15.5V)	103dB	97dB	89dB				
Summary	125Hz	250Hz	500Hz	1kHz	2kHz	4kHz	8kHz
NPA (2.83V/1m)	88dB	85dB	87dB	87dB	84dB	89dB	87dB
Opening Angle at -6dB	360°	360°	160°	120°	100°	110°	130°